

A modern commercial interior featuring a ceiling with horizontal wood slats and recessed lighting. A white marble reception desk with a black base is in the foreground. The background shows a wall of vertical wood slats and a glass partition. A black and wood chair is visible in the lower right corner.

COMMERCIAL INTERIORS



Herbert Smith Freehills Law Firm—Sydney

Our Ecolite beams and panels have been installed in many corporate offices across Australia. The Ecolite beams can be applied with many surfaces including digital print, natural timber veneer, laminate and paint.

With lightweight Balsa as the core material, Ecolite beams have distinct advantages in installation costs and the ability to create interesting profiles.



Theiss Head Office—Southbank Brisbane

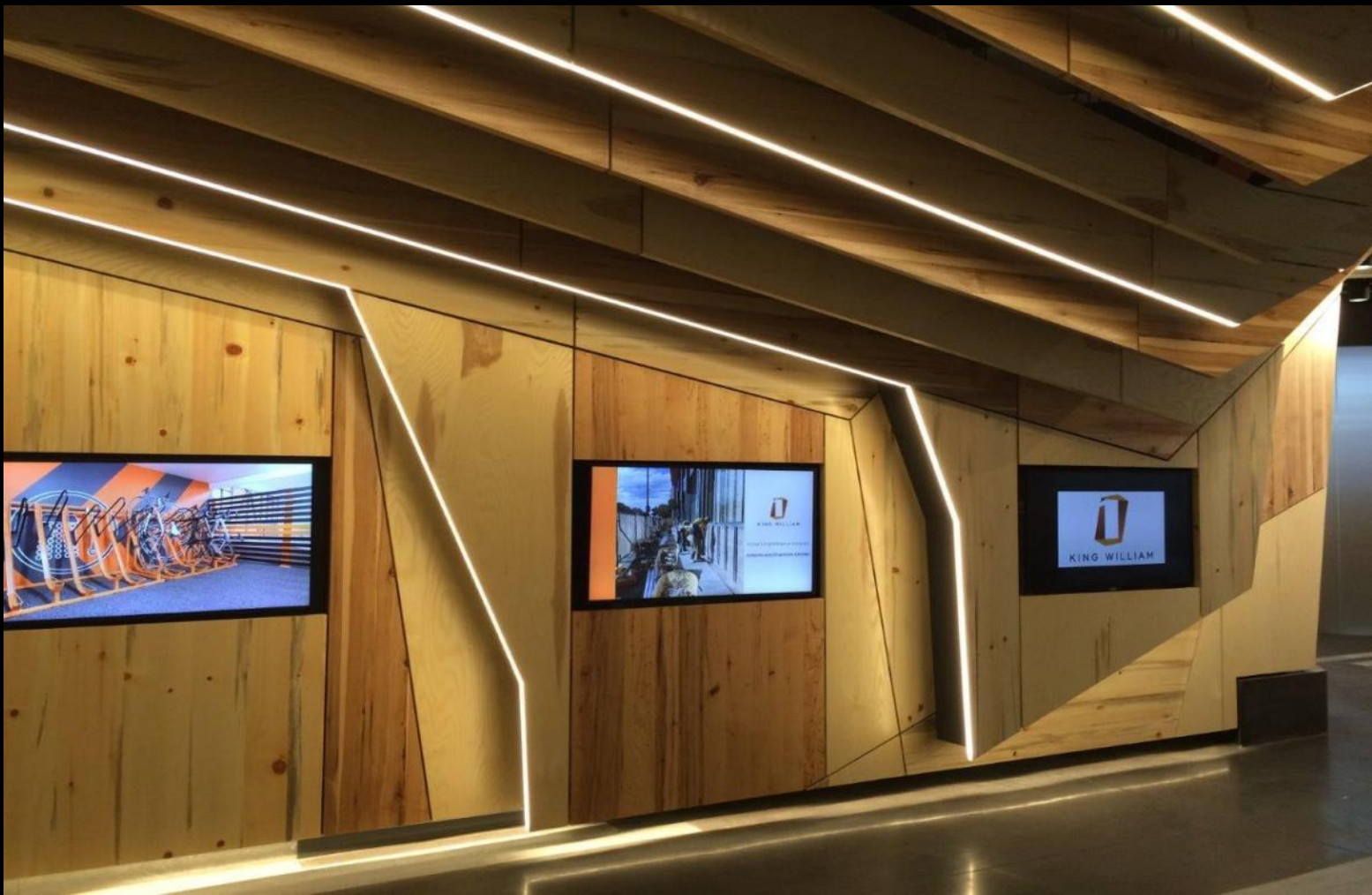

1 King William St, Adelaide Architect: IA Design Joiner: Spry & Spry Product: 35mm thick Ecolite panels with rustic veneer overlay



Corporate House—Pymble Place, Sydney Architect: Architects Dovey Product: Ecolite bateens with Spotted Gum digital print



Scottish Pacific Offices—Sydney Shopfitter: Woodland Shopfitting Product: Ecolite beams digitally printed with Spotted Gum



Brown Forman Offices—Brisbane Designer/Builder: Priority Design & Construction Corporate images digitally printed on MDF panels